



Alliance Française

Vancouver

RENT OUR

ALLIANCE FRANÇAISE VANCOUVER

SPACES

ALLIANCE FRANÇAISE

6161 Cambie St, Vancouver, BC V5Z 3B2
www.alliancefrancaise.ca



INTRODUCTION

About us

Ideally located in the dynamic Oakridge neighbourhood, our brand new building offers a new home to all cross-cultural experiences in Vancouver. **Innovative, accessible, eco aware, and community-friendly**, it is the perfect choice to host your next **cultural or corporate event**.

Whether you're looking for a **unique atmosphere** or want to make a **lasting impression**, we have everything you need to meet your requirements.

Rental Spaces

We provide **versatile rental spaces for a wide range of events**:

- Professional **Theatre** specially designed for performing arts or cinema
- Fully-equipped culinary **Demonstration Kitchen**
- Light-full **Gallery** with large windows for cocktails or receptions
- Outdoor rooftop **Patio**
- **Classrooms** for presentations or workshops

*More details about our rental spaces, rates and policies on the following pages.
Please ask for AFV Rider for any further technical information.*

THEATRE

Suggested events

Professional Theatre specifically designed for performing arts (concerts, dance shows, theatrical productions).
Also perfect for movie screenings, lectures, seminars or book launches.

i
No food or beverage are allowed in the Theatre (except water).

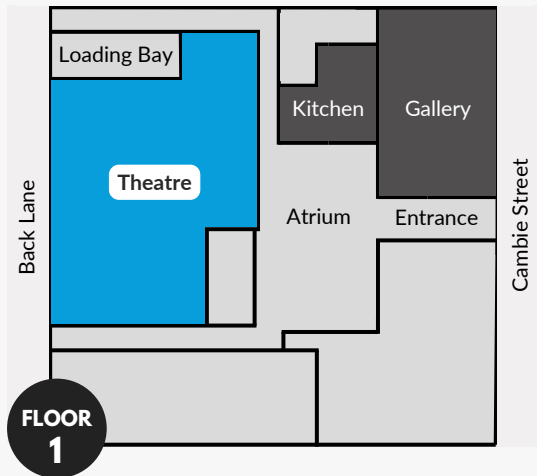

→ Dimensions and Capacities

165 seats: 150 fixed + 15 removable front row to extend option for a wider stage.

4 wheelchair spaces

Stage: 53 m² (570 sqft), Green Room: 56 m² (27 sqft), Changing Room: 18 m² (193 sqft)

📎 Equipment

Included*: Seating risers, Performance Stage, Green Room with mini-fridge and bathroom, Change Room, Loading Bay, Wifi

Additional: Professional Control Room, A/V capabilities, Professional hanging and lighting system

Rental Rates

For use of the premise and included* equipment listed above.

Minimum of 4h rental.

	MONDAY to THURSDAY		FRIDAY to SUNDAY	
	Half day 4h	Full day 8h	Half day 4h	Full day 8h
NON PROFIT	\$360	\$675	\$435	\$825
REGULAR	\$480	\$900	\$580	\$1100

Staff Rates

REQUIRED

Rental coordinator: \$35/h during the entire rental period.



ADDITIONAL

Technician: \$40/h, minimum 4h call.

Mandatory with the use of the Control Room (A/V capabilities, Professional hanging and lighting system).

GALLERY

Suggested events

Light-full Gallery with high windows. Great for meetings, cocktails, receptions, or workshops.

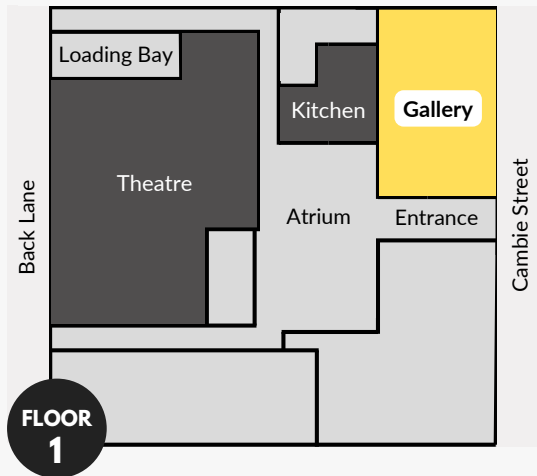

→ Dimensions and Capacities

30 people seated or 60 people standing
Room size: 104 m² (1119sqft)

📎 Equipment

Included*: Access to the Loading Bay, Wifi
Additional: Folding Chairs, High Tables, A/V capabilities, Set up of the space

✓ Catered event?

Get a package! Also rent the adjacent **Demonstration Kitchen** and benefit from a discount on the Rental Rates.

Hosting a Gala?

Get the package with the Demonstration Kitchen and **Theatre** to get the perfect combo.

Rental Rates

For use of the premise and included* equipment listed above.
Minimum of 4h rental.

	MONDAY to THURSDAY		FRIDAY to SUNDAY	
	Half day 4h	Full day 8h	Half day 4h	Full day 8h
NON PROFIT	\$210	\$390	\$360	\$675
REGULAR	\$280	\$520	\$480	\$900

Staff Rates

REQUIRED

Rental coordinator: \$35/h during the entire rental period.

ADDITIONAL

Technician: \$40/h, minimum 4h call.

Mandatory if the Rental requires specific technical needs.

DEMONSTRATION KITCHEN

Suggested events

Fully-equipped culinary Demonstration Kitchen, perfect for meetings, cocktail parties, culinary demonstrations, or wine tastings.

Food and beverage are permitted in the Demonstration Kitchen.

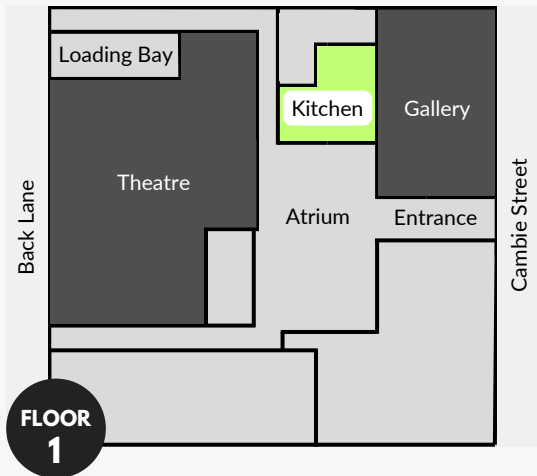

→ Dimensions and Capacities

10-12 people

Room size: 39 m² (419 sqft)

📎 Equipment

Included*: Included: Central Kitchen Island, Hot Plates, Cooking Appliances, Loading Bay, Wifi

Additional: Ecocups and Wine Glasses

✔ Get a package

Adjacent to Gallery and Theatre:
Extend possibility for larger event and benefit from a discount on the Rental Rates with a package.

Rental Rates

For use of the premise and included* equipment listed above.

Minimum of 4h rental.

	MONDAY to THURSDAY		FRIDAY to SUNDAY	
	Half day 4h	Full day 8h	Half day 4h	Full day 8h
NON PROFIT	\$135	\$255	\$210	\$390
REGULAR	\$180	\$340	\$280	\$520

Staff Rates

REQUIRED

Rental Coordinator: \$35/h during the entire rental period.

ADDITIONAL

Technician: \$40/h, minimum 4h call.

Mandatory if the Rental requires specific technical needs.

PATIO

Suggested events

Large outdoor Patio, for meetings, cocktail parties, wine tastings, or workshops.

Food and beverages are permitted in the Patio. This is an outdoor space, sounds restrictions may apply.



→ Dimensions and Capacities

30 people seated or 60 people standing

Room size: 100m² (1072ft²)

📎 Equipment

Included*: Outdoor patio furnitures, Wifi

Additional: Folding Chairs and Tables, High Tables, Ecocup, Wine Glasses, Set up of the space.

Rental Rates

For use of the premise and included* equipment listed above.

Minimum of 2h rental.

	MONDAY to THURSDAY			FRIDAY to SUNDAY		
	2h	4h	8h	2h	4h	8h
NON PROFIT	\$114	\$180	\$330	\$162	\$255	\$480
REGULAR	\$120	\$240	\$440	\$170	\$340	640

Staff Rates

REQUIRED

Rental Coordinator: \$35/h during the entire rental period.

ADDITIONAL

Technician: \$40/h, minimum 4h call.

Mandatory if the Rental requires specific technical needs.

CLASSROOMS

Suggested events

Meetings, presentations, classes or workshops.

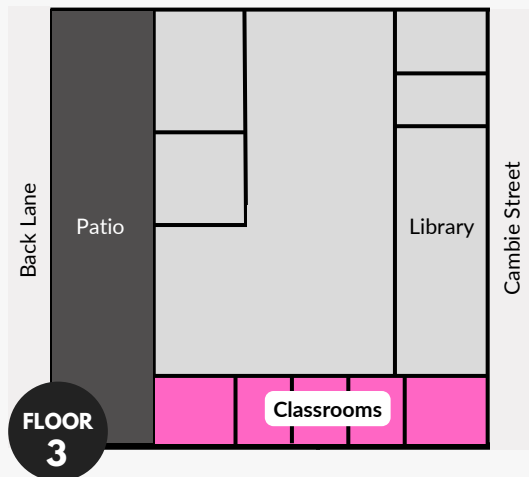

→ Dimensions and Capacities

Medium classroom: 10 people seated or 20 people standing

Large classroom: 15 people seated or 30 people standing

📎 Equipment

Included: Electronic whiteboard, video capacities, students chairs and tables, Wifi

Additional: Regular tables and chairs, Set up of the space

Rental Rates

For use of the premise and included equipment listed above.

Minimum of 2h rental.

	MONDAY to THURSDAY			FRIDAY to SUNDAY		
	2h	4h	8h	2h	4h	8h
NON PROFIT	\$37.5	\$70	\$135	\$45	\$90	\$165
REGULAR	\$50	\$100	\$180	\$60	\$120	\$220

Staff Rates

No Rental Coordinator not required for Classroom Rentals.



SIDE NOTES

Rental Period

The Rental Period may begin no earlier than 8.30am and end no later than 11.00pm and must include arrival/set-up/pre-inspection and dismantling/post-inspection/departure time. Overtime will be charged for any Rental Period exceeding 8 hours per day or for hours worked between 11:00pm and 8:30am.

Rates and Fees

For every Rental

- **Rental Rates:** For use of the premise and included equipment listed above.
- **Other fees required: Rental Coordinator:** \$35/h during the entire rental period. **Maintenance and cleaning:** The Renter is responsible to leave the place tidy; Each Rental is subject to cleaning fees depending on the rented room(s).

Additional:

Overtime; Additional Equipment and Set up; AFV Technician: The Renter may, at the sole discretion of AFV, be required to provide and pay for his own additional technician. **Any external technician shall work under AFV staff supervision.**

Payment

Payment methods accepted: **Credit card** (Visa or Mastercard) or cheques.

Under \$500:

- Full Payment in single installment
- Due 30 days from invoice date and not later than 20 days prior to the first day of the Rental Period

Over \$500:

- Payment may be in two installments
- With 50% payment due 30 days from the invoice date, and the second 50% due 30 days prior the first day of the Rental Period

Cancellation

An administrative fee equal to 10% of the total Rental Fees will automatically be charged on every cancellation made by Renter.

Payment under \$500:

- **More than 10 days** prior to the first day of the Rental Period: AFV will refund any rental fees previously paid.
- **Less than 10 days** prior to the first day of the Rental Period: Any rental fees previously paid are non-refundable.

Payment over \$500:

- **More than 30 days** prior to the first day of the Rental Period: AFV will refund any rental fees previously paid.
- **Less than 30 days** prior to the first day of the Rental Period: Any rental fees previously paid are non-refundable.

Rescheduling

No guarantee is provided by AFV regarding the ability to reschedule bookings, and any rescheduling is at the sole discretion of AFV. In the event AFV can accommodate a rescheduling requested by The Renter, administrative fees will be charged.

Insurance

The Renter is required to obtain commercial general liability and property damage insurance for the duration of the rental period with respect to Alliance Française Vancouver premises. Copy of Insurance is required to access the premises.

For further information, please contact our Rental Coordinator:



rentals@alliancefrancaise.ca



BOOK WITH US

Contact

For any **additional information**, to book a tour or to submit a **rental enquiry**.

Package rates are available upon request.

 **Louise MABILLE (She/Her)**
rentals@alliancefrancaise.ca

Our team will get back to you in the following days.

Access

Address: Alliance Française Vancouver,
6161 Cambie St, Vancouver, BC V5Z 3B2

Underground parking lot available for cars and bikes.

Easily accessible by public transportation:

- Ideally located on the Canada Line, 5 minutes away from Oakridge 41th and Langara 49th stations.
- Bus 15 from Olympic Station to Cambie also stops right in front of our building.

